

Touchless soap dispenser Amber

299-3205-2X

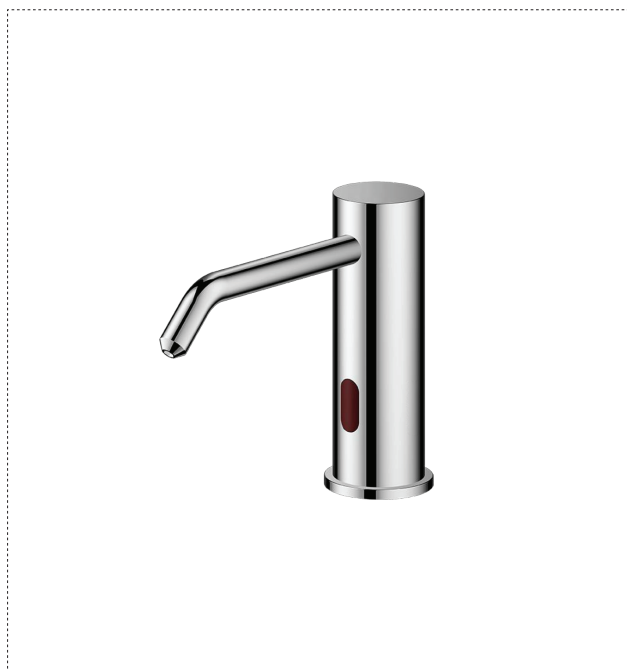

DESCRIPTION

Automatic touchless faucets and soap dispensers are hygienic and water efficient solution for your bathroom or public restrooms, such as schools, hospitals, airports, restaurants, shopping malls, cinemas. Using sensor beams the automatic faucet or soap dispenser determines when an object is in front of it and automatically turns on and automatically turn off when there is no motion.

Benefits of automatic touchless faucets and soap dispensers:

- Help to avoid spreading germs and grime, eliminate bacteria from being spread from person to person
- Reduces water waste by eliminating unnecessary and unattended water flow.
- Gives patrons confidence that their restroom experience will be clean, comfortable, and convenient.

SPECIFICATION

Type	deck-mounted soap dispenser
Sensor type	Infra-red(IR) sensor activation
Power supply	AC (110-240V)+DC (6V - 4x1.5V alkaline battery)
Power consumption (soap dispenser)	Active mode≤3.5W Standby mode≤ 0.5mW
Sensing distance	10-30 cm (adjustable by regular magnet)
Cleaning liquids type	liquid soap, foaming soap, disinfectant
Liquids bottle volume	1.6L ('MAX FILL LINE' mark)
Warranty	2 years
Certificate	CE, UKCA, SAA, UL

TECHNICAL DATA

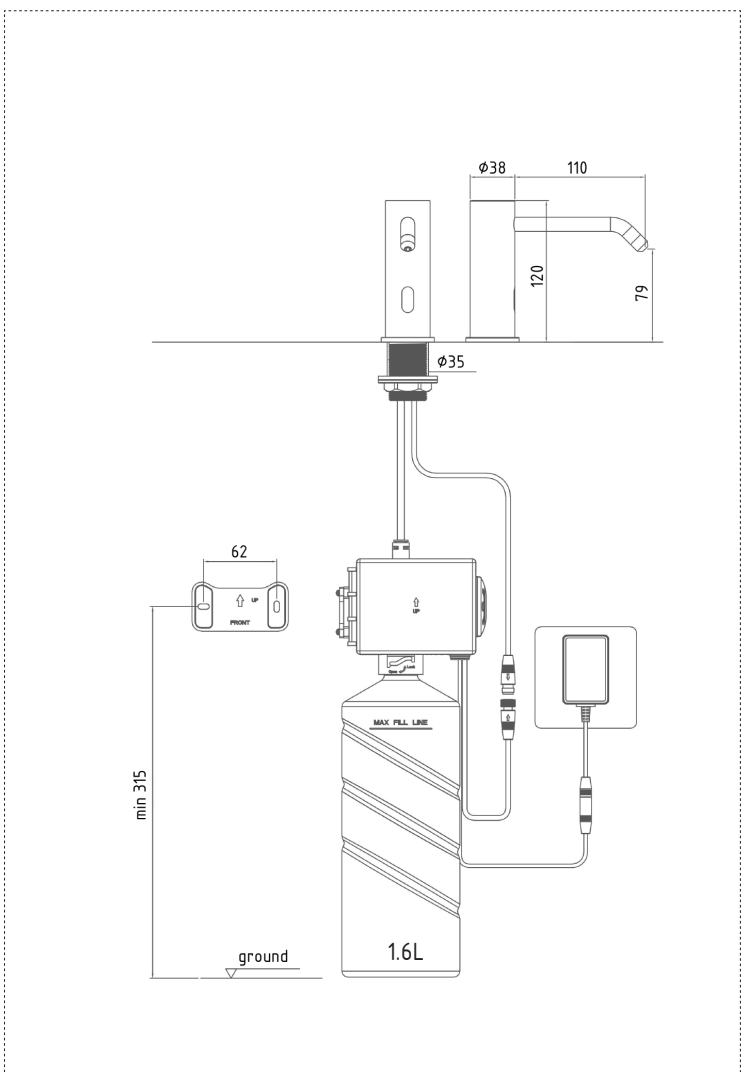
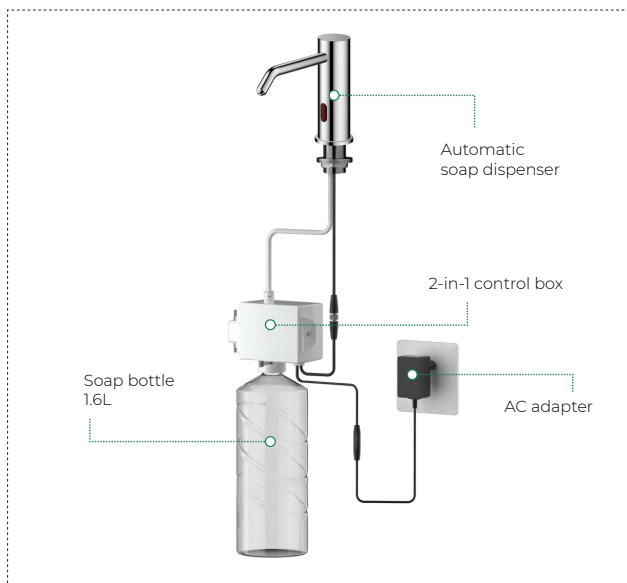

POSSIBLE SURFACE FINISHING

<p>Chrome plated (CP)</p> <p>299-3205-21</p>	<p>Black mat (BM)</p> <p>299-3205-22</p>
<p>Brushed Nickel (BN)</p> <p>299-3205-23</p>	<p>Brushed Gold (BG)</p> <p>299-3205-24</p>